



# National Detroit, Inc.

P.O. Box 2285 ■ Rockford, IL 61131  
 (815) 877-4041 ■ Fax (815) 877-4050  
 email: Sales@NationalDetroit.com  
 website: www.NationalDetroit.com

**MODEL 1100**  
 STRAIGHT-LINE

Shipping Address:  
 1590 Northrock Court  
 Rockford, IL 61103

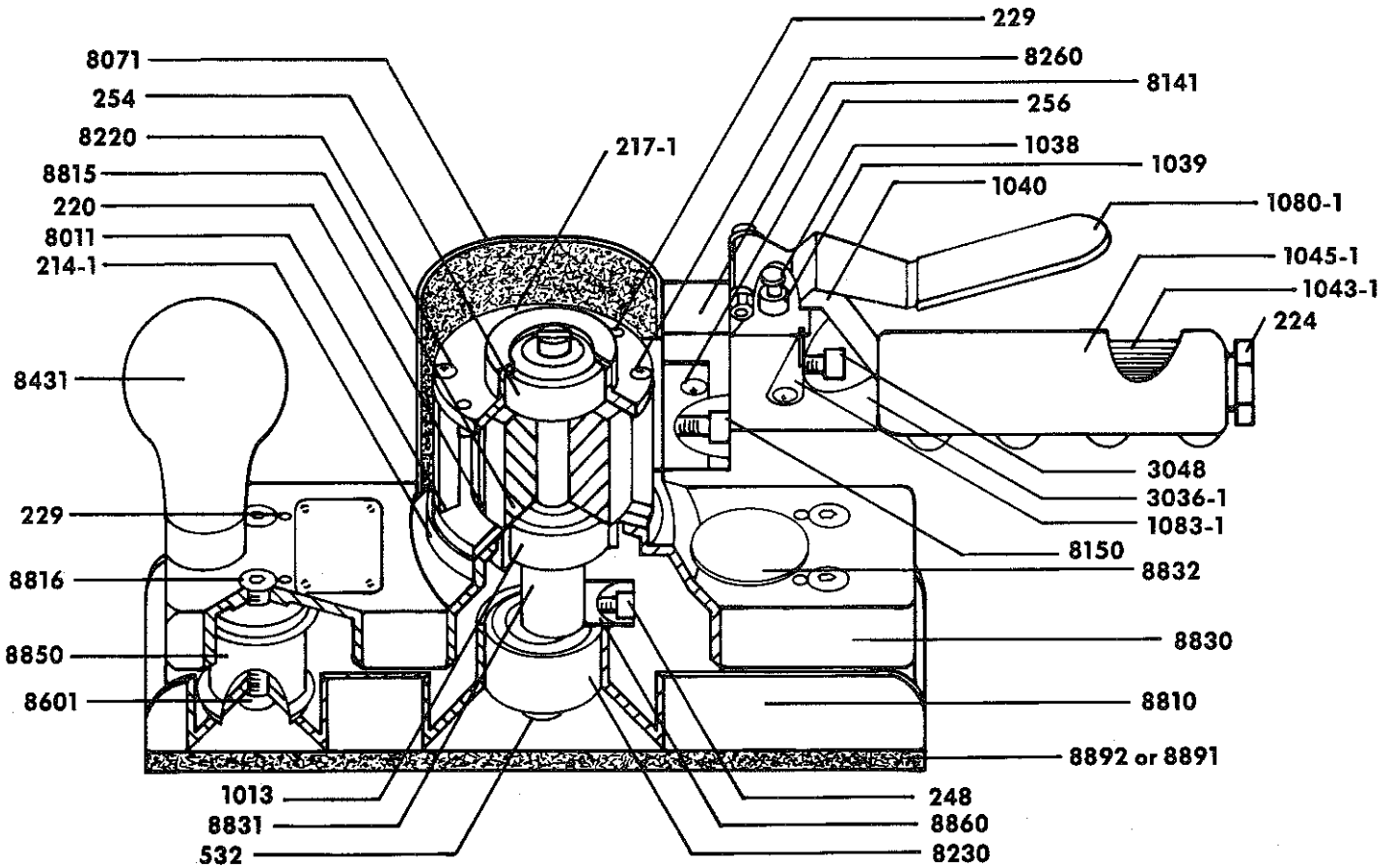

**Part No. Description**

- 214-1 Lower Motor Bearing Plate Only
- 217-1 Upper Motor Bearing Plate Only
- 220 Rotor Blade (8)
- 224 Motor Screen Plug
- 229 Dowel Pin (8) (4 in motor, 4 in thrust support)
- 246-1 Valve Spring (not shown, part of 3036-1)
- 248 Lower Counterweight Screw
- 250 Valve Plug (not shown)
- 254 Ball Bearing Upper
- 256 Cover Screw (2)
- 257 Shim (sizes available .001 thru .006, .010)
- 532 Lower Crank Screw with Washer
- 1013 Ball Bearing Lower
- 1037 Valve Ball (not shown, part of 3036-1)
- 1038 Valve Stem
- 1039 Valve Stem Sleeve
- 1040 Valve Lever
- 1042 Valve Lever Jam Nut
- 1043-1 Handle Steel (less part 224)
- 1045-1 Rear Handle Grip
- 1080-1 Valve Lever Booster Assembly
- 1080-B Valve Lever Bracket Nut
- 1080-C Valve Lever Bracket Screw
- 1083-1 Speed Control Regulator Assembly
- 3036-1 Valve Complete with Speed Control
- 3048 Valve Screw

**Optional Parts**

- 1—8891 Backing Pad Textured
- Dust Collector add 1—8910 Handle Air Tube remove 1—8832 Plug 1—1045-1 Grip

**Part No. Description**

- 8011 Motor Cylinder
- 8071 Cover
- 8141 Valve Riser Block
- 8150 Valve Riser Screw (2)
- 8220 Motor Screw with Washer (3)
- 8230 Crank Bearing
- 8260 Motor Screw (small head) (1)
- 8431 Front Handle Ball
- 8601 Screw Bottom Support (4)
- 8810 Pad Shoe
- 8815 Motor Rotor
- 8816 Screw Top Support (4)
- 8830 Motor Base
- 8831 Crankshaft
- 8832 Plug
- 8850 Thrust Support Assembly (4) with Screws
- 8860 Lower Counterweight
- 8892 Backing Pad Fine Finish—Standard
- 8850 Thrust Support Assembly
  - 4—8840 Lower Thrust Plate
  - 4—8841 Upper Thrust Plate
  - 4—8881 Boot Retainer Lower
  - 4—8882 Boot Retainer Upper
  - 4—8130 Support Boot

**NATIONAL DETROIT**  
**MODEL 1100 STRAIGHT LINE SANDER**  
**OPERATING INSTRUCTIONS**

Connect to air line equipped with filter and regulator. Adjust for 60 PSI. This is adequate for most sanding. Excessive air pressure causes unnecessary wear and may retard sanding efficiency. Never run the Sander free off of the work. Adjust speed control lever on left side of valve for best cutting speed. Sometimes a new Sander, or one being idle for a few days, will not start when the operating valve is depressed. Should this happen, hold the machine in the right hand with the operating valve pressed down. Then rest the sanding pad in the left hand and push it back and forth until the motor starts.

**LUBRICATION.** Lubrication should be performed daily. Put several drops of light oil through the air intake line daily. This will prolong tool life and prevent rust formation in the motor. If the tool is operated in conjunction

with an air line oiler, it should be adjusted to admit no more than 1 drop every five minutes. Excessive oil flow can cause an oil film deposit on the work.

**ABRASIVE PAPER SIZE 2-3/4 x 8 IN.** This tool is made to accept PSA paper only. Use standard PSA file board paper cut in 2 pieces. Finer grits are also available in 2-3/4 wide by roll size. Simply cut to 8 in. lengths to use.

**ABRASIVE PAD.** The pad supplied with this tool is the fine finish pad. This pad should be used for 180 grit and finer (up to 600). For coarser grades of paper, install the textured hard neoprene pad listed under optional parts.

When removing paper from the fine finish pad start carefully at one corner and remove slowly to prevent tearing the pad.

**CAUTION: READ AND OBSERVE THE ENCLOSED WARNINGS  
AND SAFETY RULES FOR SAFE OPERATION.**