



# National Detroit, Inc.

P.O. Box 2285 ■ Rockford, IL 61131  
(815) 877-4041 ■ Fax (815) 877-4050

**MODEL 9900**  
**9900-DE**

Shipping Address:  
1590 Northrock Court  
Rockford, IL 61103

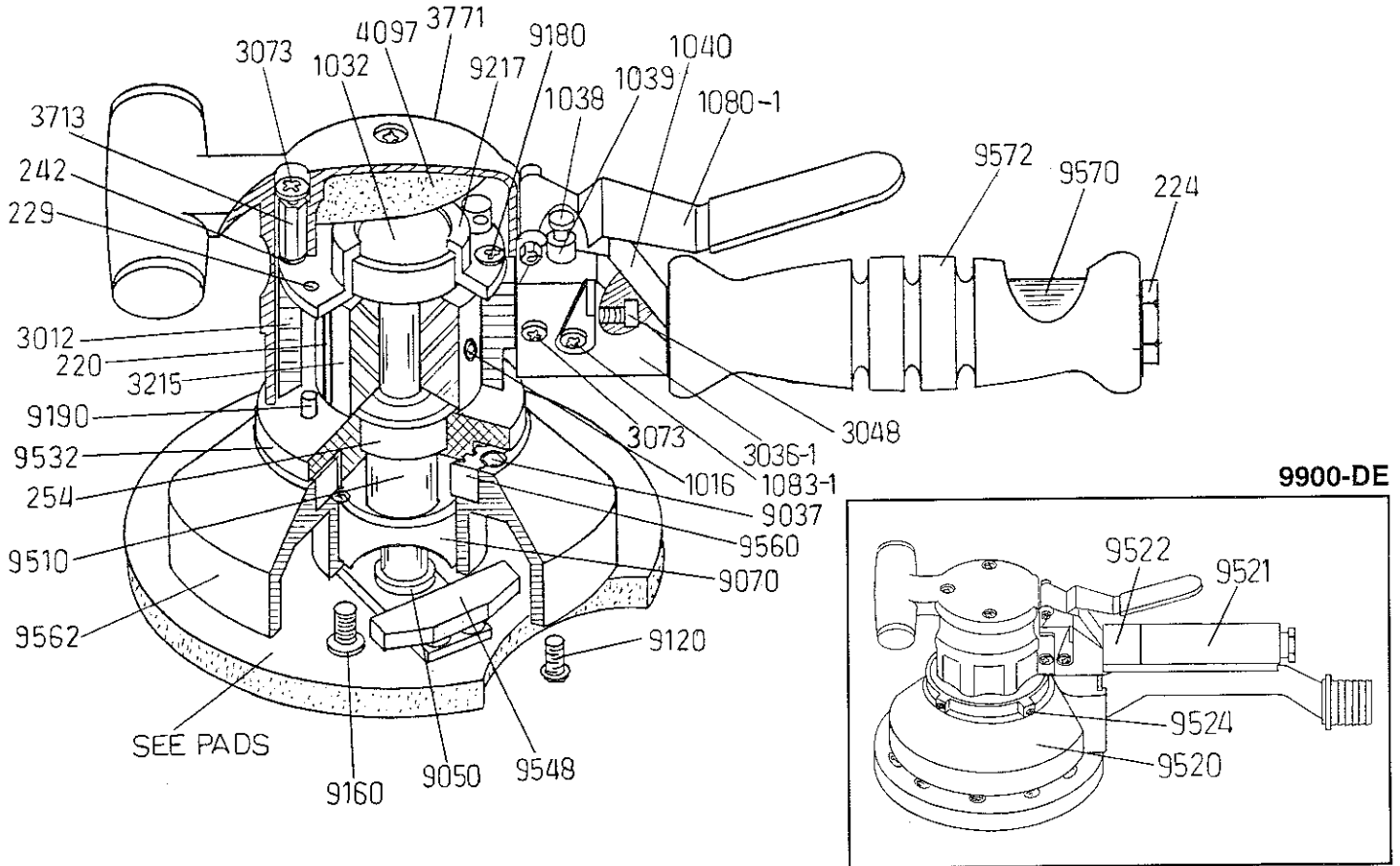

Part No.	Description
220	Rotor Blade (5)
224	Motor Screen Plug
229	Dowel Pin Upper Motor (2)
242	Washer (3)
246-1	Valve Spring
250	Valve Pipe Plug
254	Ball Bearing Motor (2)
257	Shim (sizes available .001 thru .006, .010 and .015)
1016	Rotor Set Screw
1032	Metal Gasket, Upper Motor Bearing
1037	Valve Ball
1038	Valve Stem
1039	Valve Stem Sleeve
1040	Valve Lever
1042	Valve Lever Jam Nut
1080-1	Valve Lever Booster Assembly
1080-B	Valve Lever Bracket Nut
1080-C	Valve Lever Bracket Screw
1083-1	Speed Control Regulator Assembly
3012	Motor Cylinder
3036-1	Valve Assembly complete with 1083-1
3048	Valve Screw (2)
3073	Cover Screw With Washer (5)

Part No.	Description
3215	Motor Rotor
3713	Motor Stud (3)
3771	T-Handle Cover
4097	Muffler
9037	Gear Screw (4)
9050	Counterweight Spacer
9070	Crank Bearing
9120	Pad Attaching Screw (5)
9160	Counterweight Attaching Screw
9180	Motor Screw With Lockwasher
9190	Dowel Pin Lower Motor (2)
9217	Upper Motor Bearing Plate Assembly With Bearing
9300	Screw Bearing Retainer (3)
9510	Crankshaft
9532	Lower Motor Bearing Plate Assembly With Bearing & Gear
9548	Counterweight Assembly With Screw & Pin
9560	Driven Gear
9562	Transmission Assembly With Bearing, Gear & Screws
9570	Handle
9572	Grip

Parts	Description
9577	Hook Face Pad
9580	Vinyl Face Pad
9586	DE Vinyl Face Pad
9587	DE Hook Face Pad

Dust Extraction Parts	Description
9520	Dust Shroud
9521	Air Tube Handle
9522	Handle Spacer
9524	Screw (4)
9550	DE Kit Vinyl Pad
9557	DE Kit Hook Face Pad

Buff Pads	Description
9591	7" x 1" Straight Wool Compound Pad
9592	7" Yellow Foam Compound Pad
9593	7" Gray Foam Finishing Pad
9594	7" White Twisted Wool Compound Pad
9595	7" Yellow Wool Finishing Pad

# NATIONAL-DETROIT MODEL 9900 SANDER OPERATING INSTRUCTIONS

**AIR PRESSURE:** We recommend using up to 90 PSI air supply for this tool. Use the speed control lever to adjust the speed for best performance. Never run the sander "free or wild" or on higher air pressure. Injury or damage can result. Never run the sander off the work.

**LUBRICATION:** Put several drops of light oil (10 weight) through the air intake daily. This will prolong the tool life. If the tool is

used in conjunction with an air line oiler, it should be adjusted to admit 1 drop every 5 minutes. Excessive oil flow can cause an oil film deposit on the work.

**AIR SUPPLY:** Clean, dry air is important to prevent damage and excessive wear. We recommend using a moisture trap and filter. Drain water from compressor tank daily. Keep intake filter clean.

## APPLICATION INSTRUCTIONS

**FOR SANDING:** The model 9900/9900DE is a highly aggressive tool when used for sanding and stripping. You may find that a grade or two finer paper leaves a better surface finish. In most cases one step stripping will prepare the surface for primer.

Keep the tool moving to avoid heat build-up on this material. No need to apply pressure; let the tool do the work.

Start out slow and increase the speed until you obtain the control and finish you want.

**FOR BUFFING AND POLISHING:** There are many types of wool and foam pads available that can be used on the model 9900. Make sure you have selected the correct type of pads and compound to

match the work that needs to be done. Wool and foam pads come in different grades, from very aggressive to very fine polishing and glazing. All types of polishing and buffing pads must be kept clean. Even the smallest particle of dirt or dried compound can cause scratches in a finish.

Attach the pad to the tool, making sure it is centered and runs true. Keep the tool moving at all times. In most cases the tool will operate better if it is slowed down.

Let the action of the tool do the work. Check your progress often. The unique action of the tool will do a lot of work in a short time.

**CAUTION: READ AND OBSERVE THE ENCLOSED WARNINGS AND SAFETY RULES FOR SAFE OPERATION.**